



Molded Products

April 6, 1998

Brent Damon  
Napoleon City Zoning Inspector  
255 Riverview  
Napoleon, OH 43545

Dear Brent Damon:

Here are copies of the drawings for the office trailer we discussed. Please contact me with instructions regarding any permits that I might need.

Respectfully,

A handwritten signature in blue ink, appearing to read 'Jeff Morrill'.

Jeff Morrill  
President  
Enclosures (2)

Jam:jmk

1414 N. Scott  
2

1-800-774-7444

Eric  
State Certified

X  
Signature

# SPECIFICATIONS ACE TRAILER LEASING 8 X 24 OFFICE

**DESIGN/REGISTRATION:** ASST. REC  
**CONSTRUCTION:** N/A  
**ENGINEERING:** N/A  
**INSPECTION:** FACTORY

**FRAME TYPE:** CUTRIGGER  
**I-BEAM:** 8" JR. BEAM ASTM A-36 STEEL  
**CROSSMEMBER:** ANGLE & ROD 48" O.C.  
**PAINT:** MINIMUM 3 MIL BLACK ASPHALT  
**WALLS:** (1) 7/8" 1/2" SHEET  
**FLOOR:** FIBER WITH 2 5/16" COUPLER  
**TRUCKS:** 8-PLY

**FLOORING:** FLOOR BOARD: WOVEN PLASTIC TYPE  
**INSULATION:** R-11 UNFACED  
**JOIST:** 2 X 4 #3 or BETTER SPF @ 18" O.C. (TRANSVERSE)  
**DECKING:** 5/8" SUEDE-FLOOR PLYWOOD 20 O.C. SPAN INDEX  
**COVERING:** 1/8" COVERBOWL TILE

**EXT. WALLS:** 2 X 4 STUD GRADE SPF @ 18" O.C.  
**STUDS:** 1 X 4 #3 or BETTER SPF  
**BOTTOM PLATE:** 1 X 4 #3 or BETTER SPF  
**TOP PLATE:** 1 X 4 #3 or BETTER SPF  
**WALL HEIGHT:** 7'-0"  
**WALL COVERING:** 1/2" VINYL COVERED GYPSUM (CLASS 1 F.S.)  
**INSULATION:** R-7 UNFACED  
**TRIM:** 019 ALUMINUM BAVED EMERAL FINISH  
**SIDING COLOR:** 019 ALUMINUM BAVED EMERAL FINISH  
**FRONT DESIGN:** TO BE SELECTED  
**FRONT COLOR:** TO BE SELECTED  
**FRONT DESIGN:** SQUARE

**ROOF:** STD. BOW TRUSS @ 18" O.C. 30' LIVE LOAD  
**PARTS:** 3/8" PREFINISHED GYPSUM (CLASS 1 F.S.)  
**CEILING:** R-11 UNFACED  
**INSULATION:** 30 GA. GALVANIZED  
**ROOFING:** STD. J-DAL  
**GUTTERS:** (4) OVER THE ROOF TYPE  
**TIE DOWN:**

**DOORS:** (1) 36" X 80" STANDARD W/VENTOR  
**EXT. EOOD:** RETED, KEATHER STRIP & THRESHOLD  
**HARDWARE:**  
**LOCKS:**

**WINDOWS:** (6) 36" X 27" H/S BRONZE/INSECT SCREEN  
**FRAMES:** ALUMINUM EXTRUDED & INTERIOR WOOD GRASSH  
**GLAZING:** SINGLE STRENGTH CLEAR

**INTERIOR TRIM:** STD. WOOD AND PLASTIC PROFILES

**ELECTRICAL:** 120V/240V SINGLE PHASE, 3 WIRE, 60 HZ.  
**SWITCH:** 60 AMP WITH MAIN BREAKER  
**LOAD CENTER:** 1 1/2" EMT CONDUIT  
**TRAYING:** MINIMUM 14 GA BONDIX WITH BORDAN  
**FRAMING:** (3) 4" 2-TUBE SURFACED MOUNTED STRIP  
**LIGHTS:** (5) 120 VOLT DUPLEX GROUNDING TYPE  
**RECEPTACLES:** (1) 120 VOLT TOGGLE TYPE  
**SWITCHES:** (1) 120 VOLT A/C RECEPT  
**MISC:**

**HYDRAULIC:** (2) 120 VOLT ELECTRIC GASBOARD  
**HEAT:** (1) 8,000 BTU THRU WALL A/C  
**COOLING:**

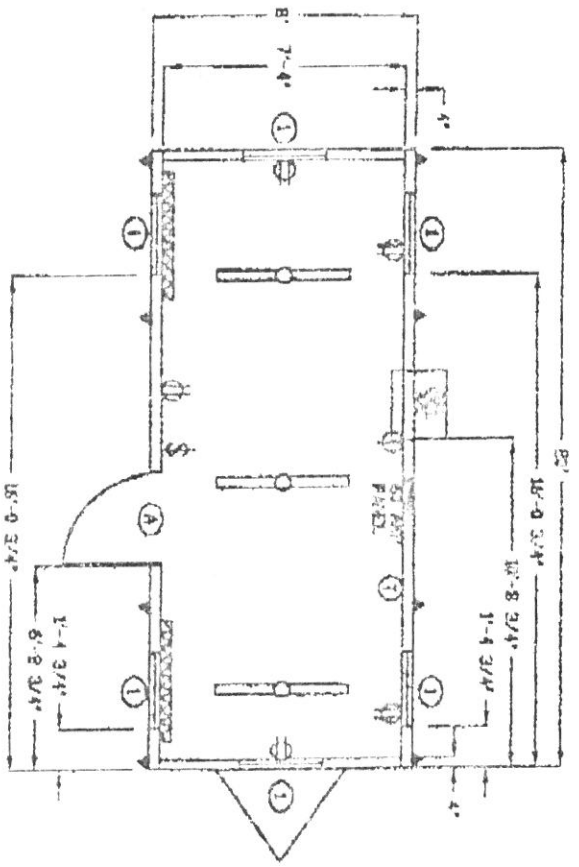

X  
Signature *[Handwritten Signature]*

DRAWING LEGEND

SYMBOL	QTY.	DESCRIPTION
○	1	160/240 VOLT ELECTRICAL PANEL
○	3	4' DOUBLE TUBE FLUOR STRIP LIGHT
○	5	120 V. DUPLEX RECEPT
○	1	120 V. SINGLE AMP RECEPT
○	1	120 V. SWITCH
○	1	THERMOSTAT
○	2	4' 120 V. WATERWARD HEATER
○	2	ICE DOWN STAMP LOCATION

DOOR & WINDOW SCHEDULE

SYMBOL	QTY.	DESCRIPTION	ROUGH OPENING
Ⓐ	1	3600 STANDARD W/ VANTIC	36 X 80
Ⓛ	6	3027 HORIZ. SLUR BRONZE FINISH	20 1/4 X 27 1/4

TITLE: ACE TRAILER LEASING  
 8X24 OFFICE

SCALE: 1/4"=1'-0"  
 DATE: 4-6-99

DRAWN BY: [Blank]  
 CHECKED BY: [Blank]

SERIAL # 98-418  
 CUSTOMER: [Blank]